

TWO-HOLE IPS GALVANIZED PIPE STRAPS



Part #	Model #	Description (Size)	Inner Carton Qty	Master Carton Qty	Select Model Below
TWO-HOLE IPS GALVANIZED PIPE STRAP					
H19542	HMGPS14	1/4" IPS GALV 2-HOLE PIPE STRAP	-	100	<input type="checkbox"/>
H19755	HMGPS38	3/8" IPS GALV 2-HOLE PIPE STRAP	-	100	<input type="checkbox"/>
H19756	HMGPS12	1/2" IPS GALV 2-HOLE PIPE STRAP	-	100	<input type="checkbox"/>
H19757	HMGPS34	3/4" IPS GALV 2-HOLE PIPE STRAP	-	100	<input type="checkbox"/>
H19758	HMGPS1	1" IPS GALV 2-HOLE PIPE STRAP	-	100	<input type="checkbox"/>
H19759	HMGPS114	1-1/4" IPS GALV 2-HOLE PIPE STRAP	-	50	<input type="checkbox"/>
H19760	HMGPS112	1-1/2" IPS GALV 2-HOLE PIPE STRAP	-	50	<input type="checkbox"/>
H19761	HMGPS2	2" IPS GALV 2-HOLE PIPE STRAP	-	50	<input type="checkbox"/>
H19762	HMGPS212	2-1/2" IPS GALV 2-HOLE PIPE STRAP	-	25	<input type="checkbox"/>
H19763	HMGPS3	3" IPS GALV 2-HOLE PIPE STRAP	-	25	<input type="checkbox"/>
H19764	HMGPS4	4" IPS GALV 2-HOLE PIPE STRAP	-	25	<input type="checkbox"/>
H19765	HMGPS6	6" IPS GALV 2-HOLE PIPE STRAP	-	25	<input type="checkbox"/>

MADE IN THE USA

MATERIAL / FINISH

- STEEL
- GALVANIZED OR GALVANEALD

PAGE 1 of 2

JOB NAME: _____

JOB LOCATION: _____

CONTRACTOR: _____

DATE: _____

ITEM TAG: _____

ENGINEER APPROVAL: _____

DATE: _____

PART NUMBER: _____

TWO-HOLE IPS GALVANIZED PIPE STRAPS

MADE IN THE USA

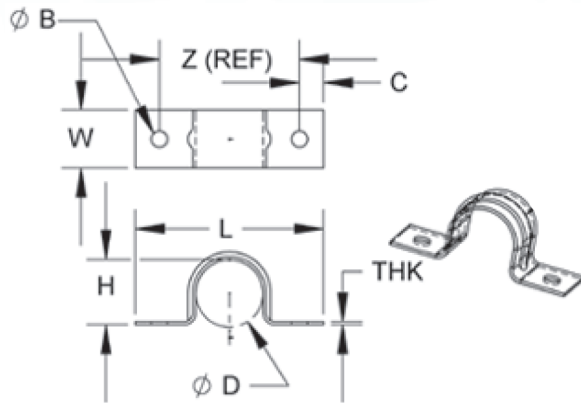

DIMENSION CHART

SIZE	D	H	THK	W	L	B	C	Z (ref)
Tol.	0.06	0.03	US GAGE	0.12	0.25	0.032	0.06	0.06
	-0.02	-0.06	MIN. THK.	-0.03	-0.12	-0.015	-0.03	-0.06
1/4	0.54	0.48	22 Ga. (.027)	0.50	1.88	0.175	0.28	1.31
3/8	0.69	0.68	22 Ga. (.027)	0.75	2.38	0.200	0.38	1.62
1/2	0.84	0.84	21 Ga. (.030)	0.75	2.62	0.200	0.38	1.80
3/4	1.05	1.05	21 Ga. (.032)	0.75	2.75	0.200	0.38	2.06
1	1.31	1.31	19 Ga. (.041)	1.00	3.40	0.281	0.38	2.62
1-1/4	1.66	1.66	16 Ga. (.055)	1.00	4.25	0.281	0.50	3.25
1-1/2	1.90	1.90	16 Ga. (.062)	1.00	4.20	0.281	0.50	3.44
2	2.38	2.38	14 Ga. (.067)	1.00	5.06	0.281	0.50	4.21
2-1/2	2.88	2.88	13 Ga. (.085)	1.00	6.31	0.340	0.62	4.88
3	3.50	3.50	13 Ga. (.085)	1.00	7.00	0.340	0.62	5.88
3-1/2	4.00	4.00	12 Ga. (.098)	1.00	7.50	0.340	0.62	6.25
4	4.50	4.50	12 Ga. (.098)	1.00	8.38	0.340	0.75	7.12
6	6.63	6.60	11 Ga. (.115)	1.25	11.12	0.340	0.81	9.50
8	8.63	8.63	11 Ga. (.115)	1.25	13.00	0.340	1.00	11.00

JOB NAME: _____

JOB LOCATION: _____

CONTRACTOR: _____ DATE: _____

ITEM TAG: _____

ENGINEER APPROVAL: _____ DATE: _____

PART NUMBER: _____