

FLEXIBLE RUBBER COUPLING



REDUCING FLEXIBLE COUPLINGS:

- HPFRC2112
- HPFRC32
- HPFRC42
- HPFRC43
- HPFRC64



PART #	MODEL #	DESCRIPTION (SIZE)	INNER CARTON QTY.	MASTER CARTON QTY.	A1	B1	L	SELECT MODEL BELOW
FLEXIBLE COUPLINGS (CI, PL, COPPER, ST (TO) CI, PL, COPPER, ST)								
H99800	HPFRC114	1-1/4" x 1-1/4"	1	100	1-37/64"	1-37/64"	3-15/32"	<input type="checkbox"/>
H99801	HPFRC112	1-1/2" x 1-1/2"	1	50	1-29/32"	1-29/32"	3-31/64"	<input type="checkbox"/>
H99802	HPFRC2112	2" x 1-1/2"	1	50	2-23/64"	1-57/64"	3-15/32"	<input type="checkbox"/>
H99803	HPFRC2	2" x 2"	1	50	2-3/8"	2-3/8"	3-31/64"	<input type="checkbox"/>
H99804	HPFRC32	3" x 2"	1	30	3-1/2"	2-13/32"	3-61/64"	<input type="checkbox"/>
H99805	HPFRC3	3" x 3"	1	30	3-15/32"	3-15/32"	3-31/32"	<input type="checkbox"/>
H99806	HPFRC42	4" x 2"	1	30	4-13/32"	2-3/8"	3-7/8"	<input type="checkbox"/>
H99807	HPFRC43	4" x 3"	1	30	4-13/32"	3-35/64"	4-17/64"	<input type="checkbox"/>
H99808	HPFRC4	4" x 4"	1	30	4-31/64"	4-31/64"	3-31/32"	<input type="checkbox"/>
H99809	HPFRC64	6" x 4"	1	12	6-25/64"	4-13/32"	5-53/64"	<input type="checkbox"/>
H99810	HPFRC6	6" x 6"	1	12	6-29/64"	6-29/64"	5-29/32"	<input type="checkbox"/>
H99811	HPFRC8	8" x 8"	1	20	8-5/8"	8-5/8"	6"	<input type="checkbox"/>

- Meets ASTM C1173-10e1
- Clamps are 301 Stainless Steel

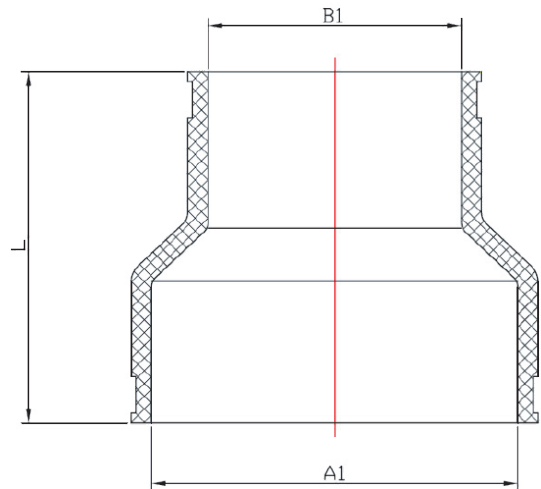

JOB NAME: _____

JOB LOCATION: _____

CONTRACTOR: _____ **DATE:** _____

ENGINEER APPROVAL: _____ **DATE:** _____

ITEM TAG: _____

PART NUMBER: _____