



BRASS GATE VALVE WITH SWEAT CONNECTION

PART #	MODEL #	DESCRIPTION	INNER CARTON QTY.	MASTER CARTON QTY.	SELECT MODEL BELOW
BRASS GATE VALVE with SWEAT CONNECTION (LEAD-FREE)					
H51110	HPVSG12LF	1/2" x 1/2" IPS GATE VALVE	10	120	<input type="checkbox"/>
H51111	HPVSG34LF	3/4" x 3/4" IPS GATE VALVE	10	80	<input type="checkbox"/>
H51112	HPVSG1LF	1" x 1" IPS GATE VALVE	5	60	<input type="checkbox"/>
H82320	HPVSG114LF	1-1/4" x 1-1/4" IPS GATE VALVE	5	50	<input type="checkbox"/>
H51113	HPVSG112LF	1-1/2" x 1-1/2" IPS GATE VALVE	2	24	<input type="checkbox"/>
H51114	HPVSG2LF	2" x 2" IPS GATE VALVE	2	12	<input type="checkbox"/>
H51115	HPVSG212	2-1/2" x 2-1/2" IPS GATE VALVE	1	8	<input type="checkbox"/>
H82321	HPVSG3	3" x 3" IPS GATE VALVE	1	6	<input type="checkbox"/>

FEATURES & MATERIALS

- Brass Body
- 1/2" - 2" Valves **ARE** Lead-Free
- Sweat Connection
- 2-1/2" - 4" Valves **ARE NOT** Lead Free
- Non-Rising Stem
- 200 PSI / WOG
- Lead Free



WARNING: Can expose you to lead, a carcinogen and reproductive toxicant. See www.P65Warnings.ca.gov.

JOB NAME:

JOB LOCATION:

CONTRACTOR:

DATE:

ITEM TAG:

ENGINEER APPROVAL:

DATE:

PART NUMBER:

BRASS GATE VALVE WITH SWEAT CONNECTION

ITEM #	DESCRIPTION	D	H	L	D1	D2
HPVSG12LF	1/2"	Ø2.086	2.638	1.705	Ø.629	Ø.512
HPVSG34LF	3/4"	Ø2.086	2.913	2.205	Ø.878	Ø.669
HPVSG1LF	1"	Ø2.322	3.189	2.598	Ø1.129	Ø.768
HPVSG114LF	1-1/4"	Ø3.071	3.661	2.913	Ø1.378	Ø1.102
HPVSG112LF	1-1/2"	Ø3.071	4.291	3.149	Ø1.629	Ø1.339
HPVSG2LF	2"	Ø3.071	5.236	3.661	Ø2.129	Ø1.713

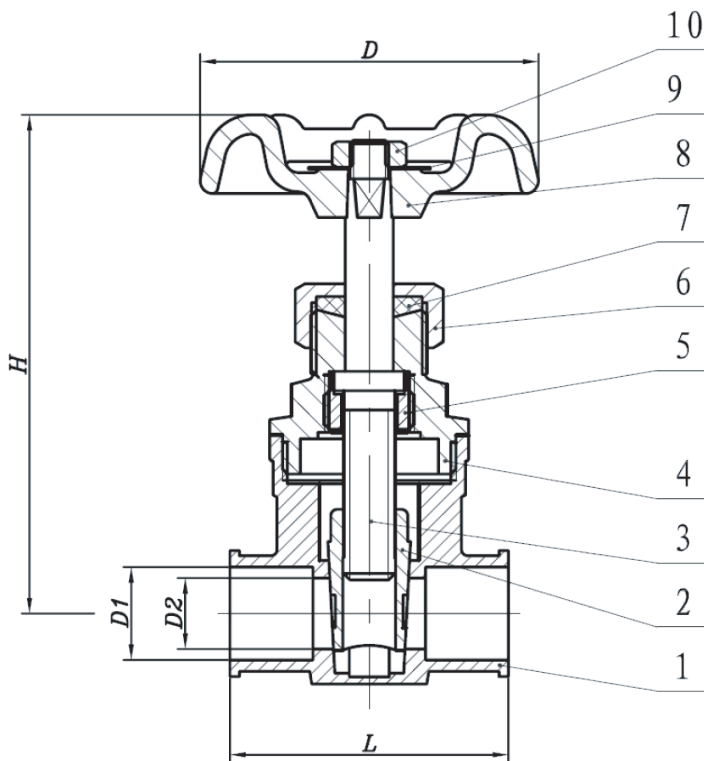

NO.	PART	MATERIAL
1	Body	Lead Free Brass
2	Disc	Lead Free Brass
3	Stem	Lead Free Brass
4	Bonnet	Lead Free Brass
5	Lock Nut	Lead Free Brass
6	Nut	Brass
7	Gland Packing	PTFE
8	Hand Wheel	Cast Iron
9	Name Plate	Aluminum
10	Nut	Q235 Steel



WARNING: Can expose you to lead, a carcinogen and reproductive toxicant. See www.P65Warnings.ca.gov.

JOB NAME:

JOB LOCATION:

CONTRACTOR:

DATE:

ITEM TAG:

ENGINEER APPROVAL:

DATE:

PART NUMBER: