

**COPPER RISER CLAMPS**



PART #	MODEL #	DESCRIPTION	INNER CARTON QTY	MASTER CARTON QTY	SELECT MODEL BELOW
<b>COPPER RISER CLAMPS</b>					
H33617	HMRC12C	1/2" Copper Riser Clamp	1	25	<input type="checkbox"/>
H33618	HMRC34C	3/4" Copper Riser Clamp	1	25	<input type="checkbox"/>
H33619	HMRC1C	1" Copper Riser Clamp	1	25	<input type="checkbox"/>
H33620	HMRC114C	1-1/4" Copper Riser Clamp	1	25	<input type="checkbox"/>
H33621	HMRC112C	1-1/2" Copper Riser Clamp	1	25	<input type="checkbox"/>
H33622	HMRC2C	2" Copper Riser Clamp	1	25	<input type="checkbox"/>
H33623	HMRC212C	2-1/2" Copper Riser Clamp	1	25	<input type="checkbox"/>
H33624	HMRC3C	3" Copper Riser Clamp	1	25	<input type="checkbox"/>
H33625	HMRC4C	4" Copper Riser Clamp	1	25	<input type="checkbox"/>



**COPPER RISER CLAMPS** | Dimensions (IN)

SIZE	A	STOCK	BOLT
1/2"	7.0"	1/8" x 1"	1/4" x 1"
3/4"	7.0"	1/8" x 1"	1/4" x 1"
1"	9.0"	1/8" x 1"	1/4" x 1"
1-1/4"	9.5"	1/8" x 1"	1/4" x 1"
1-1/2"	10.0"	1/8" x 1"	1/4" x 1"
2"	10.5"	1/8" x 1-1/4"	5/16" x 1-1/4"
2-1/2"	11.0"	5/32" x 1"	3/8" x 1-1/4"
3"	11.5"	5/32" x 1"	3/8" x 1-1/4"
4"	13.0"	1/8" x 1-1/2"	3/8" x 1-1/4"

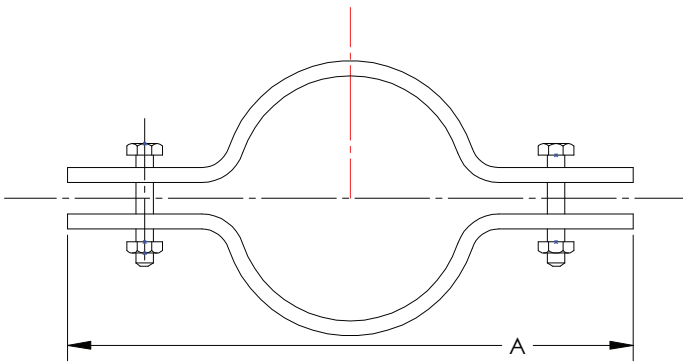

**FINISH:** Copper-Colored Epoxy Finish (PC)

**FEATURES:** • Maximum Temperature: 450° F

- Conforms with Federal Specification WW-H-171 (Type 8), Manufacturers Standardization Society (MSS) SP-58 (Type 8).

**JOB NAME:** \_\_\_\_\_

**JOB LOCATION:** \_\_\_\_\_

**CONTRACTOR:** \_\_\_\_\_ **DATE:** \_\_\_\_\_

**ITEM TAG:** \_\_\_\_\_

**ENGINEER APPROVAL:** \_\_\_\_\_ **DATE:** \_\_\_\_\_

**PART NUMBER:** \_\_\_\_\_