

## STANDARD ELECTROPLATED CLEVIS PIPE HANGER



PART #	MODEL #	DESCRIPTION	INNER CARTON QTY	MASTER CARTON QTY	SELECT MODEL BELOW
<b>STANDARD ELECTROPLATED CLEVIS PIPE HANGERS</b>					
H33500	HMCL12E	1/2" Standard Plated Clevis Hanger	1	50	<input type="checkbox"/>
H33501	HMCL34E	3/4" Standard Plated Clevis Hanger	1	50	<input type="checkbox"/>
H33502	HMCL1E	1" Standard Plated Clevis Hanger	1	50	<input type="checkbox"/>
H33503	HMCL114E	1-1/4" Standard Plated Clevis Hanger	1	50	<input type="checkbox"/>
H33504	HMCL112E	1-1/2" Standard Plated Clevis Hanger	1	50	<input type="checkbox"/>
H33505	HMCL2E	2" Standard Plated Clevis Hanger	1	50	<input type="checkbox"/>
H33506	HMCL212E	2-1/2" Standard Plated Clevis Hanger	1	25	<input type="checkbox"/>
H33507	HMCL3E	3" Standard Plated Clevis Hanger	1	25	<input type="checkbox"/>
H33508	HMCL312E	3-1/2" Standard Plated Clevis Hanger	1	25	<input type="checkbox"/>
H33509	HMCL4E	4" Standard Plated Clevis Hanger	1	25	<input type="checkbox"/>
H33510	HMCL5E	5" Standard Plated Clevis Hanger	1	25	<input type="checkbox"/>
H33511	HMCL6E	6" Standard Plated Clevis Hanger	1	25	<input type="checkbox"/>
H33512	HMCL8E	8" Standard Plated Clevis Hanger	1	25	<input type="checkbox"/>
H33513	HMCL10E	10" Standard Plated Clevis Hanger	1	EACH	<input type="checkbox"/>
H33514	HMCL-12E	12" Standard Plated Clevis Hanger	1	EACH	<input type="checkbox"/>
H33516	HMCL-14E	14" Standard Plated Clevis Hanger	1	EACH	<input type="checkbox"/>
-	HMCL-16E	16" Standard Plated Clevis Hanger	1	EACH	<input type="checkbox"/>
-	HMCL-18E	18" Standard Plated Clevis Hanger	1	EACH	<input type="checkbox"/>
-	HMCL-20E	20" Standard Plated Clevis Hanger	1	EACH	<input type="checkbox"/>
-	HMCL-24E	24" Standard Plated Clevis Hanger	1	EACH	<input type="checkbox"/>

**MATERIAL:** Steel, Zinc-Plated

**FEATURES:** • Complies with MSS SP-58 (Type 1) and WW-H-171 (Type 1)  
• UL Listed applies to 1/2" - 8" • FM Approved applies to 3/4" - 6"

**JOB NAME:** \_\_\_\_\_

**JOB LOCATION:** \_\_\_\_\_

**CONTRACTOR:** \_\_\_\_\_ **DATE:** \_\_\_\_\_ **ITEM TAG:** \_\_\_\_\_

**ENGINEER APPROVAL:** \_\_\_\_\_ **DATE:** \_\_\_\_\_ **PART NUMBER:** \_\_\_\_\_

## STANDARD ELECTROPLATED CLEVIS PIPE HANGER

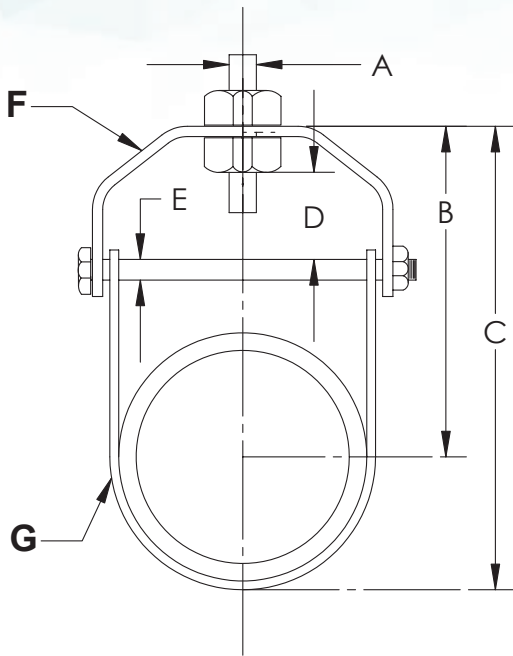

SIZE	A	B	C	D	E	F	G	MAX REC LOAD (lbs)
1/2	3/8	1.7	2.5	0.62	1/4	.080 X 1.00	.070 X 1.00	250
3/4	3/8	2.0	2.8	0.62	1/4	.080 X 1.00	.070 X 1.00	250
1	3/8	2.3	3.0	0.62	1/4	.080 X 1.00	.070 X 1.00	250
1-1/4	3/8	2.5	3.5	0.75	1/4	.085 X 1.00	.070 X 1.00	250
1-1/2	3/8	2.8	3.8	1.00	1/4	.085 X 1.00	.070 X 1.00	250
2	3/8	3.0	4.0	1.30	1/4	12 ga X 1.00	.080 X 1.00	300
2-1/2	1/2	3.5	5.3	1.30	5/16	11 ga X 1.25	13 ga X 1.25	350
3	1/2	4.8	7.0	2.00	5/16	11 ga X 1.25	13 ga X 1.25	350
4	1/2	5.8	8.0	2.00	3/8	8 ga X 1.25	11 ga X 1.25	500
5	5/8	6.5	9.5	2.30	1/2	3 ga X 1.25	8 ga X 1.25	700
6	3/4	7.5	10.5	2.30	1/2	3 ga X 1.50	8 ga X 1.50	800
8	3/4	8.8	13.0	2.30	9/16	3 ga X 1.75	8 ga X 1.75	1500
10	7/8	10.0	15.0	2.30	3/4	3/8 X 1.75	3 ga X 1.75	2500
12	7/8	11.0	18.0	2.60	3/4	3/8 X 2.00	3 ga X 2.00	3500
Complies with Manufacturers Standardization Society								
MSS-SP-58 Type-1 and WWH-171E Type-1								

**MATERIAL:** Steel, Zinc-Plated

**FEATURES:** • Complies with MSS SP-58 (Type 1) and WW-H-171 (Type 1)  
 • UL Listed applies to 1/2" - 8" • FM Approved applies to 3/4" - 6"

JOB NAME:

JOB LOCATION:

CONTRACTOR:

DATE:

ITEM TAG:

ENGINEER APPROVAL:

DATE:

PART NUMBER: