

CATO ADA ELONGATED 1.28 TOILET TULIPAN | WHITE



TUL1105



TUL1105RH

MODEL #	DESCRIPTION	SKID QTY.	PRODUCT
ADA Elongated 1.28 Tulipan Toilet White			
TUL1105	1.28 GPF TULIPAN 2652 LEFT HAND CHROME TRIP TANK (WHITE)	24	
TUL1105RH	1.28 GPF TULIPAN 2652 RIGHT HAND CHROME TRIP TANK (WHITE)	24	
TUL0405	ADA ELONGATED TOILET TULIPAN BOWL (WHITE)	18	

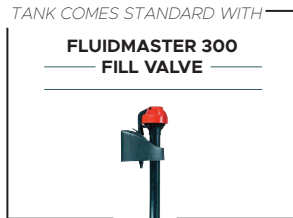

- WATER CONSUMPTION:** 4.8 IPD
- SYSTEM:** DESTROYER FLUSH 3"
- WATER SPOT DIMENSION:** 6-1/2" X 8-1/2"
- TRAP DIMENSION:** 2-3/8"
- INCLUDED:** INSTALLATION FITTINGS
- ACTUATOR:** FRONT HANDLE
- HEIGHT:** 16-1/2"
- WEIGHT:** 72.5 LBS
- VOLUME:** 0.1395

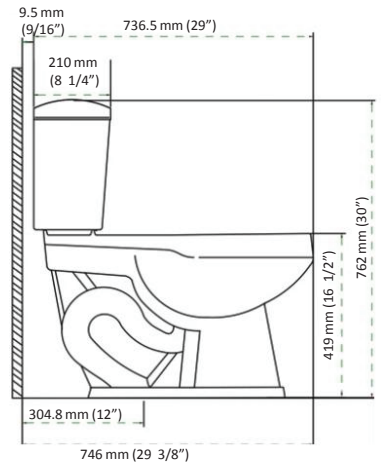
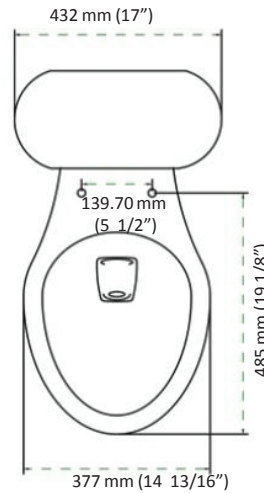

JOB NAME:

JOB LOCATION:

CONTRACTOR:

DATE:

ENGINEER APPROVAL:

DATE:

ITEM TAG:

PART NUMBER:



Complies with ADA & ICC A117.1 accessibility requirements when installed according to the requirements outlined in these standards.



Listed by IAPMO® as meeting the applicable requirements of the Uniform Plumbing Code®, International Plumbing Code®, and National Plumbing Code of Canada.

CATO ADA ELONGATED 1.28 TOILET TULIPAN | WHITE



INSTALLATION PROCEDURE GUIDE

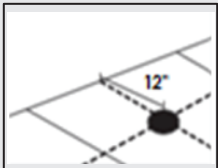

1.- Mark on the floor with a pencil or chalk color, the lines that cross through the center drain pipe. Place the toilet bowl with reference to the midline horizontal and mark the points through the holes in the base of the bowl, that will serve to prepare the holes where the anchors and Screw will be placed to attach the toilet.

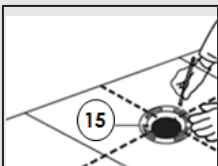

2.- Remove the toilet bowl and install anchors, place and secure the flange to the floor with the screws (20), put the screws through the flange channel, parallel to the wall. If you use wax neck make sure it is well adhered to the base of the toilet bowl.



3.- Place the toilet bowl by passing the lag screws (20) through the holes of the base, push down to connect to the flange and then rotate to ensure that the toilet bowl will stay well seated on the surface.

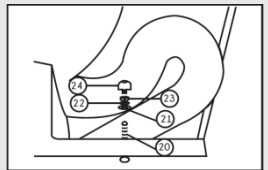

4.- Adjust the based bolt caps (21), metal washers (22), lock nuts (23) and bolt caps (24) on the toilet lag screws (20), then tighten up moderately to attach well.

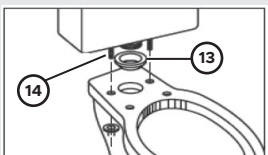

5.- To install the tank is necessary to insert the sponge gasket (13) from the threaded portion of the valve, once is installed, set the tank on the bowl making sure the holes match for the assembly of the 2 pieces (tnk / bwl) Insert the bolts (14) inside the tank by placing the tapered gasket on the screw downwards and tighten the nut (11) moderately to fix the tank.

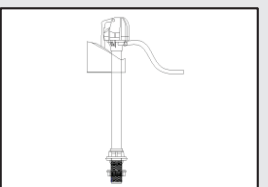

6.- To adjust the water level to the marked level in the tank, push the latch and lift the float to raise the water level to decrease and lower.

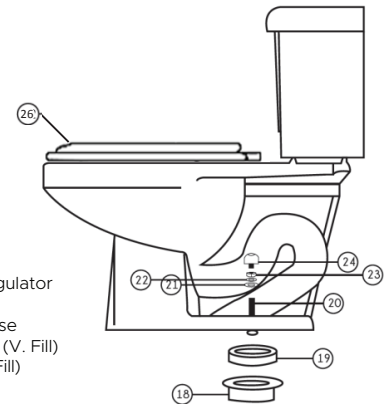

- 1.-Fill Valve
- 2.-Insurance regulator
- 3.-Float
- 4.-Recovery hose
- 5.-Cone gasket (V. Fill)
- 6.-Locknut (V. Fill)
- 7.-Flush Valve
- 8.-Flapper
- 9.-Cordon shutter
- 10.-Clip
- 11.-Cone Gasket (V. Flush)
- 12.- Valve nut
- 13.-Sponge Gasket
- 14.-Bolts Tank
- 15.-Conic Packing
- 16.-Hexagonal nut
- 17.-Handle
- 18.-Flange
- 19.-Wax ring
- 20.- Lag Screws
- 21.- Bolt caps base
- 22.- Metal washers
- 23.- Nuts
- 24.- Bolts caps
- 25.- Fill valve hose
- 26.- Seat (Only CATOPACK)

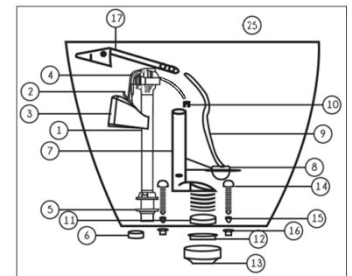

WARRANTY INFORMATION

This product is warranted for manufacturing defects for 5 years in ceramics and 1 year in tank fittings, from date of purchase. It is considered out of warranty, if the user changes any of the original parts of the product.